

K-31

3-4



STOPE BOOK

PENNSYLVANIA MINE

SOUTH

18-18

SILVER BOW MINE

5749-5750

5749
5750

K
31
~
34



For a Duplicate of this
Book give the following

No. 12770

Ind. Phone 2007

Bessette-Stork Company

Printers and Bookbinders

21 E. Quartz Street

BUTTE, MONT.

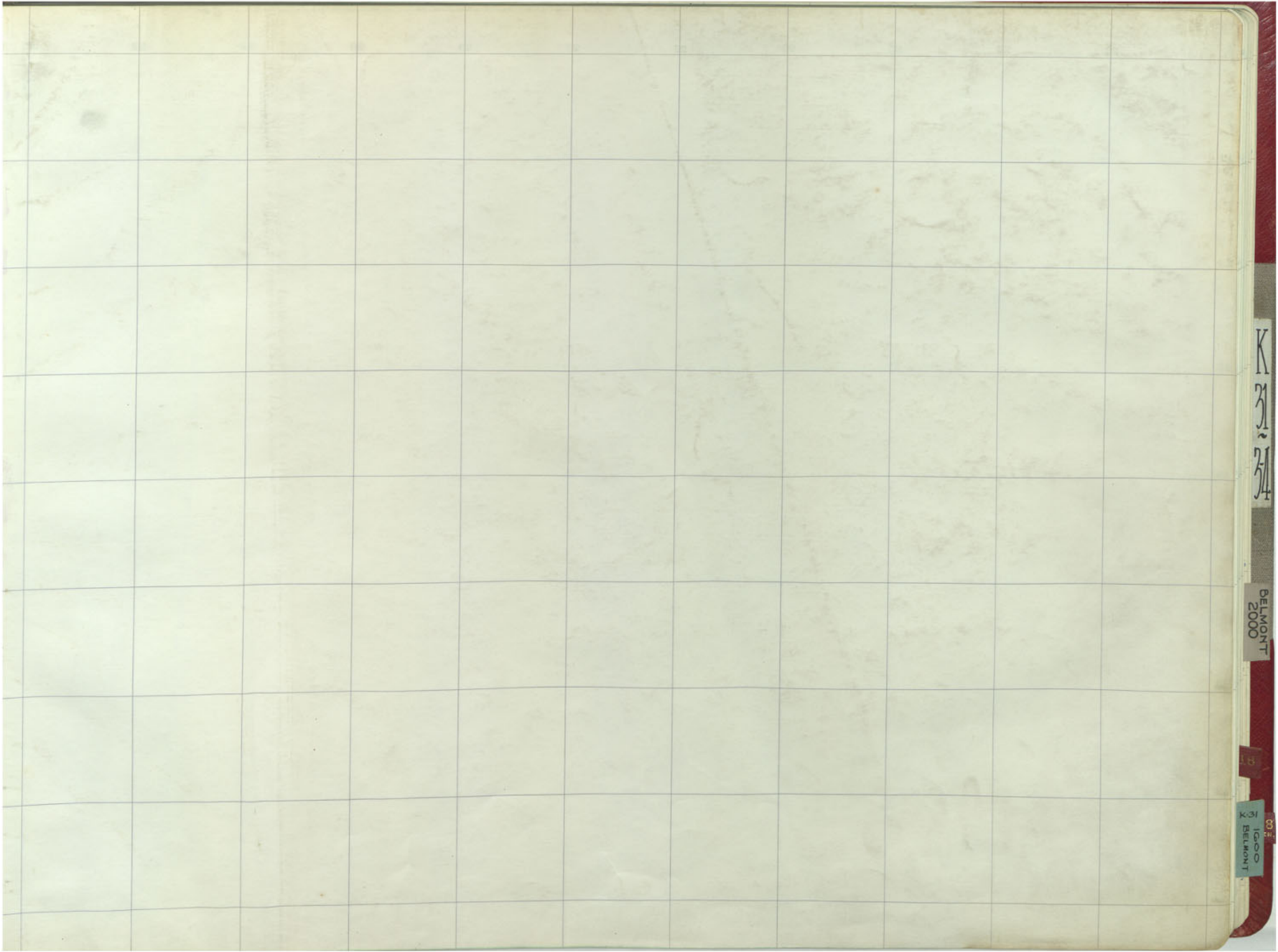

K
31
34

BELMONT
2000

10-00
K BELMONT

3223

20

23

24

25

26

27

28

29

30

31

32

33

19

18

17

16

15

14

13

12

K
31
~
34

33

34

35

36

37

38

39

40

41

42

43

20

19

18

17

16

15

14

13

12

K
31
34

BELMONT
2000

1000
K BELMONT

3224

20	23	24	25	26	27	28	29	30	31	32	33
19											
18											
17											
16											
15											
14											
13											
12											

K
31
~
34

33

34

35

36

37

38

39

40

41

42

43

20

19

18

17

16

15

14

13

12

K
31
34

BELMONT
2000

1000
K
BELMONT

3225

20	23	24	25	26	27	28	29	30	31	32	33
19											
18											
17											
16											
15											
14											
13											
12											

K
31
~
34

33

34

35

36

37

38

39

40

41

42

43

20

19

18

17

16

15

14

13

12

K
31
34

DELMONT
2000

1000
DELMONT

3226

20	23	24	25	26	27	28	29	30	31	32	33
19											
18											
17											
16											
15											
14											
13											
12											

K
31
~
34

33

34

35

36

37

38

39

40

41

42

43

20

19

18

17

16

15

14

13

12

K
31
34

BELMONT
2000

1000
K BELMONT

3227

20	23	24	25	26	27	28	29	30	31	32	33
19											
18											
17											
16											
15											
14											
13											
12											

K
31
~
34

33

34

35

36

37

38

39

40

41

42

43

20

19

18

17

16

15

14

13

12

K
31
34

BELMONT
2000

001
1600
K BELMONT

20	23	24	25	26	27	28	29	30	31	32	33
19											
18											
17											
16											
15											
14											
13											
12											

K
31
~
34

33 34 35 36 37 38 39 40 41 42 43 20

19

18

17

16

15

14

13

12

K
31
34

BELMONT
2000

CO
K
1600
K
BELMONT

3229

20	23	24	25	26	27	28	29	30	31	32	33
19											
18											
17											
16											
15											
14											
13											
12											

K
31
~
34

33

34

35

36

37

38

39

40

41

42

43

20

19

18

17

16

15

14

13

12

K
31
34

BELMONT
2000

1001
1000
K BELMONT

20	23	24	25	26	27	28	29	30	31	32	33
19											
18											
17											
16											
15											
14											
13											
12											

K
31
~
34

33

34

35

36

37

38

39

40

41

42

43

20

19

18

17

16

15

14

13

12

K
31
34

BELMONT
2000

001
K 1600
K BELMONT

3231

20	23	24	25	26	27	28	29	30	31	32	33
19											
18											
17											
16											
15											
14											
13											

K
31
~
34

33 34 35 36 37 38 39 40 41 42 43 20

19

18

17

16

15

14

13

12

K
31
34

BELMONT
2000

1000
K BELMONT

3232

20	23	24	25	26	27	28	29	30	31	32	33
19											
18											
17											
16											
15											
14											
13											
12											

K
31
~
34

33

34

35

36

37

38

39

40

41

42

43

20

19

18

17

16

15

14

13

12

K
31
34

BELMONT
2000

13

1900
K BELMONT

3233

² 20	23	24	25	26	27	28	29	30	31	32	33
¹ 19											
¹ 18											
¹ 17											
¹ 16											
¹ 15											
¹ 14											
¹ 13											
¹ 12											

K
31
~
34

33

34

35

36

37

38

39

40

41

42

43

20

19

18

17

16

15

14

13

12

K
31
34

BELMONT
2000

1000
K
1000
K
BELMONT

20 23 24 25 26 27 28 29 30 31 32 33

119

118

117

116

115

114

113

112

K
31
~
34

33

34

35

36

37

38

39

40

41

42

43

20

19

18

17

16

15

14

13

12

K
31
32
34

BELMONT
2000

1000
K BELMONT

20	23	24	25	26	27	28	29	30	31	32	33
119											
118											
117											
116											
115											
114											
113											
112											

K
31
~
34

33 34 35 36 37 38 39 40 41 42 43 20

19

18

17

16

15

14

13

12

K
31
34

BELMONT
2000

1000
K BELMONT

20	23	24	25	26	27	28	29	30	31	32	33
19											
18											
17											
16											
15											
14											
13											
12											

K
31
~
34

33

34

35

36

37

38

39

40

41

42

43

20

19

18

17

16

15

14

13

12

K
31
34

BELMONT
2000

100
K
1000
K
BELMONT

20	23	24	25	26	27	28	29	30	31	32	33
19											
18											
17											
16											
15											
14											
13											
12											

K
31
34

33

34

35

36

37

38

39

40

41

42

43

20

19

18

17

16

15

14

13

12

K
31
34

BELMONT
2000

100
K
1600
K
BELMONT

20	23	24	25	26	27	28	29	30	31	32	33
19											
18											
17											
16											
15											
14											
13											
12											

7
1
4

33

34

35

36

37

38

39

40

41

42

43

20

19

18

17

16

15

14

13

12

K
31
34

BELMONT
2000

1900
K BELMONT

20	23	24	25	26	27	28	29	30	31	32	33
19											
18											
17											
16											
15											
14											
13											
12											

7
1
4

33 34 35 36 37 38 39 40 41 42 43 20

19

18

17

16

15

14

13

12

K
31
34

BELMONT
2000

01
1000
K BELMONT

20	23	24	25	26	27	28	29	30	31	32	33
19											
18											
17											
16											
15											
14											
13											
12											

K
31
~
34

33 34 35 36 37 38 39 40 41 42 43 20

19

18

17

16

15

14

13

12

K
31
34

BELMONT
2000

001
K 1600
K BELMONT

20	23	24	25	26	27	28	29	30	31	32	33
19											
18											
17											
16											
15											
14											
13											
12											

K
31
~
34

33 34 35 36 37 38 39 40 41 42 43 20

19

18

17

16

15

14

13

12

K
31
34

BELMONT
2000

001
K 1000
K BELMONT

20	23	24	25	26	27	28	29	30	31	32	33
19											
18											
17											
16											
15											
14											
13											
12											

K
31
34

33

34

35

36

37

38

39

40

41

42

43

20

19

18

17

16

15

14

13

12

K
31
34

BELMONT
2000

03
1600
X BELMONT

2	20	23	24	25	26	27	28	29	30	31	32	33
1	19											
1	18											
1	17											
1	16											
1	15											
1	14											
1	13											
2	12											

K
31
~
34

33

34

35

36

37

38

39

40

41

42

43

20

19

18

17

16

15

14

13

12

K
31
34

BELMONT
2000

K-3
1600
BELMONT

01

21

20	23	24	25	26	27	28	29	30	31	32	33
19											
18											
17											
16											
15											
14											
13											
12											

K
31
~
34

33	34	35	36	37	38	39	40	41	42	43	20
											19
											18
											17
											16
											15
											14
											13
											12

K
31
34

BELMONT
2000

K-31
1600
BELMONT

20	23	24	25	26	27	28	29	30	31	32	33
19											
18											
17											
16											
15											
14											
13											
12											

K
31
~
34

33

34

35

36

37

38

39

40

41

42

43

20

19

18

17

16

15

14

13

12

K
31
34

BELMONT
2000

15
1000
BELMONT

2 20 23 24 25 26 27 28 29 30 31 32 33

1 19

1 18

1 17

1 16

1 15

1 14

1 13

1 12

K
M
A

33

34

35

36

37

38

39

40

41

42

43

20

19

18

17

16

15

14

13

12

K
31
34

BELMONT
2000

012
K
1000
BELMONT

2	20	23	24	25	26	27	28	29	30	31	32	33
1	19											
1	18											
1	17											
1	16											
1	15											
1	14											
1	13											
1	12											

K
M
A

33

34

35

36

37

38

39

40

41

42

43

20

19

18

17

16

15

14

13

12

K
31
34

BELMONT
2000

1900
K
BELMONT

220	23	24	25	26	27	28	29	30	31	32	33
119											
118											
117											
116											
115											
114											
113											
112											

K
M
~
H

33 34 35 36 37 38 39 40 41 42 43 20

19

18

17

16

15

14

13

12

K
31
34

BELMONT
2000

1900
K
BELMONT

3249

20	23	24	25	26	27	28	29	30	31	32	33
1119											
1118											
1117											
1116											
1115											
1114											
1113											
113											

K
31
4

33

34

35

36

37

38

39

40

41

42

43

20

19

18

17

16

15

14

13

12

K
31
34

BELMONT
2000

012
K
1000
BELMONT

20 23 24 25 26 27 28 29 30 31 32 33

119

118

117

116

115

114

113

12

K
31
~
34

33 34 35 36 37 38 39 40 41 42 43 20

19

18

17

16

15

14

13

12

K
31
34

BELMONT
2000

1000
K
BELMONT

20	23	24	25	26	27	28	29	30	31	32	33
119											
118											
117											
116											
115											
114											
113											
112											

K
31
~
34

33 34 35 36 37 38 39 40 41 42 43 20

19

18

17

16

15

14

13

12

K
31
34

BELMONT
2000

K 31
1000
BELMONT

9252

2	20	23	24	25	26	27	28	29	30	31	32	33
1	19											
1	18											
1	17											
1	16											
1	15											
1	14											
1	13											
1	12											

K
31
34

33

34

35

36

37

38

39

40

41

42

43

20

19

18

17

16

15

14

13

12

K
31
34

BELMONT
2000

K 31
1000
BELMONT

20	23	24	25	26	27	28	29	30	31	32	33
1119											
1118											
1117											
1116											
1115											
1114											
1113											
12											

K
31
~
34

33

34

35

36

37

38

39

40

41

42

43

20

19

18

17

16

15

14

13

12

K
31
34

BELMONT
2000

K 31
1000
BELMONT

01

3254

20	23	24	25	26	27	28	29	30	31	32	33
1119											
1118											
1117											
1116											
1115											
1114											
1113											
1112											

K
31
~
34

33

34

35

36

37

38

39

40

41

42

43

20

19

18

17

16

15

14

13

12

K
31
34

BELMONT
2000

K
31
BELLMONT

2000

2220	23	24	25	26	27	28	29	30	31	32	33
1119											
1118											
1117											
1116											
1115											
1114											
1113											
1112											

K
31
~
34

33 34 35 36 37 38 39 40 41 42 43 20

19

18

17

16

15

14

13

12

K
31
34

BELMONT
2000

K 31
1000
BELMONT

22	20	23	24	25	26	27	28	29	30	31	32	33
11	19											
11	18											
11	17											
11	16											
11	15											
11	14											
11	13											
11	12											

K
31
~
34

33

34

35

36

37

38

39

40

41

42

43

20

19

18

17

16

15

14

13

12

K
31
34

BELMONT
2000

K-31
1600
BELMONT

131
PKH

	20	23	24	25	26	27	28	29	30	31	32	33
1119												
1118												
1117												
1116												
1115												
1114												
1113												
1112												

K
31
~
34

33

34

35

36

37

38

39

40

41

42

43

20

19

18

17

16

15

14

13

12

K
3
3
34

BELMONT
2000

1000
K BELMONT

1000
K BELMONT

20	23	24	25	26	27	28	29	30	31	32	33
11 19											
11 18											
11 17											
11 16											
11 15											
11 14											
11 13											
12											

K
31
~
34

33

34

35

36

37

38

39

40

41

42

43

20

19

18

17

16

15

14

13

12

K
3
3
3

BELMONT
2000

1000
K BELMONT

18
FEB

3259

20	23	24	25	26	27	28	29	30	31	32	33
11 19											
11 18											
11 17											
11 16											
11 15											
11 14											
11 13											
12											

K
31
~
34

33	34	35	36	37	38	39	40	41	42	43	20
											19
											18
											17
											16
											15
											14
											13
											12

K
3
3
34

BELMONT
2000

1000
K
BELMONT

10
1000
BELMONT

2	20	23	24	25	26	27	28	29	30	31	32	33
1	19											
1	18											
1	17											
1	16											
1	15											
1	14											
1	13											
1	12											

K
31
~
34

33

34

35

36

37

38

39

40

41

42

43

20

19

18

17

16

15

14

13

12

K
3
3
3

BELMONT
2000

1000
K
BELMONT

8
7

20 23 24 25 26 27 28 29 30 31 32 33

11 19

11 18

11 17

11 16

11 15

11 14

11 13

12

K
31
~
34

33

34

35

36

37

38

39

40

41

42

43

20

19

18

17

16

15

14

13

12

K
3
3
3
4

BELMONT
2000

1000
K BELMONT

10
1000

20	23	24	25	26	27	28	29	30	31	32	33
19											
18											
17											
16											
15											
14											
13											
12											

K
31
~
34

33 34 35 36 37 38 39 40 41 42 43 20

19

18

17

16

15

14

13

12

K
3
3
4

BELMONT
2000

1000
K BELMONT

20	23	24	25	26	27	28	29	30	31	32	33
19											
18											
17											
16											
15											
14											
13											
12											

K
31
64

33

34

35

36

37

38

39

40

41

42

43

20

19

18

17

16

15

14

13

12

K
3
34

BELMONT
2000

18

13
K-3
BELMONT

13
K-3

	20	23	24	25	26	27	28	29	30	31	32	33
111	19											
111	18											
111	17											
111	16											
111	15											
111	14											
111	13											
111	12											

K
31
64

33

34

35

36

37

38

39

40

41

42

43

20

19

18

17

16

15

14

13

12

K
3
34

BELMONT
2000

K-3
BELMONT

13
K-3

20	23	24	25	26	27	28	29	30	31	32	33
111 19											
111 18											
111 17											
111 16											
111 15											
111 14											
111 13											
111 12											

K
61
74

33

34

35

36

37

38

39

40

41

42

43

20¹

19¹

18¹

17⁷

16³

15²

14

13²

12

K
3
3
4

BELMONT
2000

IC-00
K BELMONT

82
K

3266

20	23	24	25	26	27	28	29	30	31	32	33
11119											
11118											
11117											
11116											
11115											
11114											
11113											
11112											

K
31
4

33

34

35

36

37

38

39

40

41

42

43

20

19

18

17

16

15

14

13

12

K
3
3
4

BELMONT
2000

K-3
1000
BELMONT

13
K-3

3267

22 20 23 24 25 26 27 28 29 30 31 32 33

11 119

11 118

11 117

11 116

11 115

11 114

11 113

11 112

K
31
~
34

33	34	35	36	37	38	39	40	41	42	43	20
											19
											18
											17
											16
											15
											14
											13
											12

K
31
32
33
34

BELMONT
2000

K-31
10-00
BELMONT

13
K-31

20 23 24 25 26 27 28 29 30 31 32 33

19

18

17

16

15

14

13

12

K
31
~
34

33 34 35 36 37 38 39 40 41 42 43 20

19

18

17

16

15

14

13

12

K
3
3
3

BELMONT
2000

K-31
16-00
BELMONT

18
7

3269

22	20	23	24	25	26	27	28	29	30	31	32	33
11	19											
11	18											
1	17											
1	16											
1	15											
1	14											
1	13											
1	12											

K
31
~
34

33 34 35 36 37 38 39 40 41 42 43 20

19

18

17

16

15

14

13

12

K
3
34

BELMONT
2000

K-31
1600
BELMONT

18
7th

3270

22 20 23 24 25 26 27 28 29 30 31 32 33

1531
19

111 19

111 18

1 17

1 16

1 15
16039
19

1 14

1 13

1 12

BELMONT 1600 SILL

K
31
~
34

33	34	35	36	37	38	39	40	41	42	43	20
											19
											18
											17
											16
											15
											14
											13
											12

K
3
3
34

BELMONT
2000

K-31
1000
BELMONT

10
K-31

3271

20	23	24	25	26	27	28	29	30	31	32	33
19											
18											
17											
16											
15											
14											
13											
12											

K
31
~
34

1000 K
BELMONT

33

34

35

36

37

38

39

40

41

42

43

20

19

18

17

16

15

14

13

12

K
3
3
3

BELMONT
2000

18

3272

22	20	23	24	25	26	27	28	29	30	31	32	33
11	19											
11	18											
11	17											
11	16											
11	15											
11	14											
11	13											
11	12											

K
31
~
34

1000 K-31
BELMONT

33

34

35

36

37

38

39

40

41

42

43

20

19

18

17

16

15

14

13

12

K
3
34

BELMONT
2000

13

3273

20	23	24	25	26	27	28	29	30	31	32	33
19											
18											
17											
16											
15											
14											
13											
12											

K
31
34

1600 K
BELMONT

33

34

35

36

37

38

39

40

41

42

43

20

19

18

17

16

15

14

13

12

K
3
3
4

BELMONT
2000

13

13

2

112	20	23	24	25	26	27	28	29	30	31	32	33
111	19											
110	18											
109	17											
108	16											
107	15											
106	14											
105	13											
104	12											

K
31
34

1000 K
BELMONT

33

34

35

36

37

38

39

40

41

42

43

20

19

18

17

16

15

14

13

12

K
3
3
4

BELMONT
2000

18

18

3275

20	23	24	25	26	27	28	29	30	31	32	33
19											
18											
17											
16											
15											
14											
13											
12											

K
31
34

1000 K
BELMONT 2

33

34

35

36

37

38

39

40

41

42

43

20

19

18

17

16

15

14

13

12

K
3
3
4

BELMONT
2000

18

20	23	24	25	26	27	28	29	30	31	32	33
19											
18											
17											
16											
15											
14											
13											
12											

K
31
~
34

1000 K
BELMONT 2

33

34

35

36

37

38

39

40

41

42

43

20

19

18

17

16

15

14

13

12

K
3
3
34

BELMONT
2000

8

18
FEB.

20 23 24 25 26 27 28 29 30 31 32 33

19

18

17

16

15

14

13

12

K
31
34

1000 K
BELMONT 31

33 34 35 36 37 38 39 40 41 42 43 20

19

18

17

16

15

14

13

12

K
3
3
3

BELMONT
2000

8

18
FEB.

2

20	23	24	25	26	27	28	29	30	31	32	33
19											
18											
17											
16											
15											
14											
13											
12											

K
31
~
34

1000 7
BELMONT 2

33 34 35 36 37 38 39 40 41 42 43 20

19

18

17

16

15

14

13

12

K
3
3
3
4

BELMONT
2000

8

18
7th

3279

20	23	24	25	26	27	28	29	30	31	32	33
19											
18											
17											
16											
15											
14											
13											
12											

K
31
34

1600 K
BELMONT

33	34	35	36	37	38	39	40	41	42	43	20
											19
											18
											17
											16
											15
											14
											13
											12

K
3
3
4

BELMONT
2000

8

18
FEB.

20	23	24	25	26	27	28	29	30	31	32	33
19											
18											
17											
16											
15											
14											
13											
12											

K
31
~
34

1000 K
BELMONT

33

34

35

36

37

38

39

40

41

42

43

20

19

18

17

16

15

14

13

12

K
31
32
34

BELMONT
2000

18

18
FEB.

20	23	24	25	26	27	28	29	30	31	32	33
19											
18											
17											
16											
15											
14											
13											
12											

K
31
~
34

1000 K
BELMONT

33

34

35

36

37

38

39

40

41

42

43

20

19

18

17

16

15

14

13

12

K
31
31
34

BELMONT
2000

13
FEB

20	23	24	25	26	27	28	29	30	31	32	33
19											
18											
17											
16											
15											
14											
13											
12											

K
31
34

1600
BELMONT

33	34	35	36	37	38	39	40	41	42	43	20
											19
											18
											17
											16
											15
											14
											13
											12

K
31
32
33
34

BELMONT
2000

13
FEB.

3283

20	23	24	25	26	27	28	29	30	31	32	33
119											
118											
117											
116											
115											
114											
113											
112											

K
31
34

1600 K
BELMONT

33

34

35

36

37

38

39

40

41

42

43

20

19

18

17

16

15

14

13

12

K
31
32
33
34

BELMONT
2000

13
FEB.

20	23	24	25	26	27	28	29	30	31	32	33
19											
18											
17											
16											
15											
14											
13											
12											

1301

K
31
34

1000
BELMONT

33

34

35

36

37

38

39

40

41

42

43

20

19

18

17

16

15

14

13

12

K
31
31
34

BELMONT
2000

13
FEB.

S. Low 1300

3285

20	23	24	25	26	27	28	29	30	31	32	33
19											
18											
17											
16											
15											
14											
13											
12											

K
31
34

1000 K
BELMONT 31

33

34

35

36

37

38

39

40

41

42

43

20

19

18

17

16

15

14

13

12

K
31
32
33
34

BELMONT
2000

18
FEB

3286

20	23	24	25	26	27	28	29	30	31	32	33
19											
18											
17											
16											
15											
14											
13											
12											

K
31
34

1000 K
BELMONT 3

33

34

35

36

37

38

39

40

41

42

43

20

19

18

17

16

15

14

13

12

K
31
32
33
34

BELMONT
2000

13
FEB

20	23	24	25	26	27	28	29	30	31	32	33
19											
18											
17											
16											
15											
14											
13											
12											

K
31
34

1600 K
BELMONT 31

33

34

35

36

37

38

39

40

41

42

43

20

19

18

17

16

15

14

13

12

K
31
32
33
34

BELMONT
2000

18
FEB

3288

20	23	24	25	26	27	28	29	30	31	32	33
19											
18											
17											
16											
15											
14											
13											
12											

K
31
~
34

1600
K
BELMONT 31

35

34

35

36

37

38

39

40

41

42

43

20

19

18

17

16

15

14

13

12

K
31
32
34

BELMONT
2000

13

13
FEB

3289

20	23	24	25	26	27	28	29	30	31	32	33
19											
18											
17											
16											
15											
14											
13											
12											

K
31
~
34

1600
K
BELMONT 31

33 34 35 36 37 38 39 40 41 42 43 20

19

18

17

16

15

14

13

12

K
31
34

BELMONT
2000

18

18
FEB

3290

20	23	24	25	26	27	28	29	30	31	32	33
19											
18											
17											
16											
15											
14											
13											
12											

K
31
~
34

1600
K
BELMONT

33 34 35 36 37 38 39 40 41 42 43 20

19

18

17

16

15

14

13

12

K
31
32
33
34

BELMONT
2000

18

18
FEB

3291

20 23 24 25 26 27 28 29 30 31 32 33

19

18

17

16

15

14

13

12

K
31
~
34

1600
K-31
BELMONT

33	34	35	36	37	38	39	40	41	42	43	20
											19
											18
											17
											16
											15
											14
											13
											12

K
31
34

BELMONT
2000

18

18
FEB

3292

20	23	24	25	26	27	28	29	30	31	32	33
19											
18											
17											
16											
15											
14											
13											
12											

K
31
~
34

1600
K-31
BELMONT

33	34	35	36	37	38	39	40	41	42	43	20
											19
											18
											17
											16
											15
											14
											13
											12

K
31
34

BELMONT
2000

18

18
FEB

3293

20	23	24	25	26	27	28	29	30	31	32	33
19											
18											
17											
16											
15											
14											
13											
12											

K
31
~
34

1600
K-31
BELMONT

33	34	35	36	37	38	39	40	41	42	43	20
											19
											18
											17
											16
											15
											14
											13
											12

K
31
34

BELMONT
2000

8

13
FEB

3294

12	20	23	24	25	26	27	28	29	30	31	32	33
19												
18												
17												
16												
15												
14												
13												
12												

K
31
~
34

1000
K-31
BELMONT

33	34	35	36	37	38	39	40	41	42	43	20
											19
											18
											17
											16
											15
											14
											13
											12

K
31
34

BELMONT
2000

6

13
FEB

3295

12	20	23	24	25	26	27	28	29	30	31	32	33
19												
18												
17												
16												
15												
14												
13												
12												

K
31
~
34

1000 K
BELMONT 31

33	34	35	36	37	38	39	40	41	42	43	20
											19
											18
											17
											16
											15
											14
											13
											12

K
31
31
34

BELMONT
2000

6

13
FEB

3296

120	23	24	25	26	27	28	29	30	31	32	33
19											
18											
17											
16											
15											
14											
13											
12											

K
31
~
34

1000
K-31
BELMONT

33	34	35	36	37	38	39	40	41	42	43	20
											19
											18
											17
											16
											15
											14
											13
											12

K
31
31
34

BELMONT
2000

8

13
FREN

20	23	24	25	26	27	28	29	30	31	32	33
19											
18											
17											
16											
15											
14											
13											
12											

K
31
~
34

1000 K
BELMONT 31

33

34

35

36

37

38

39

40

41

42

43

20

19

18

17

16

15

14

13

12

K
31
32
34

BELMONT
2000

6

13
FEB

3298

12	20	23	24	25	26	27	28	29	30	31	32	33
19												
18												
17												
16												
15												
14												
13												
12												

K
31
~
34

1600 X
BELMONT

33

34

35

36

37

38

39

40

41

42

43

20

19

18

17

16

15

14

13

12

K
31
31
34

BELMONT
2000

6

13
FEB

3299

20	23	24	25	26	27	28	29	30	31	32	33
19											
18											
17											
16											
15											
14											
13											
12											

K
31
~
34

1600
K
BELMONT

35	34	35	36	37	38	39	40	41	42	43	20, 1
											19, 9
											18, 8
											17, 7
											16, 6
											15, 5
											14, 4
											13, 3
											12, 2

K
31
34

BELMONT
2000

18

18
PEN

12	20	23	24	25	26	27	28	29	30	31	32	33
19												
18												
17												
16												
15												
14												
13												
12												

K
31
~
34

1600 X
BELMONT

33	34	35	36	37	38	39	40	41	42	43	20, 1
											19, 9
											18, 8
											17, 7
											16, 6
											15, 5
											14, 4
											13, 3
											12, 2

K
31
34

BELMONT
2000

18

FEN

3301

20	23	24	25	26	27	28	29	30	31	32	33
19											
18											
17											
16											
15											
14											
13											
12											

K
31
~
34

1600
BEL MONT

33

34

35

36

37

38

39

40

41

42

43

20, 1

19, 9

18, 8

17, 7

16, 6

15, 5

14, 4

13, 3

12, 2

K
31
32
33
34

BELMONT
2000

18

FEB

18

3302

20	23	24	25	26	27	28	29	30	31	32	33
19											
18											
17											
16											
15											
14											
13											
12											

K
31
~
34

1600 K
BELMONT

33

34

35

36

37

38

39

40

41

42

43

20

19

18

17

16

15

14

13

12

K
31
32
33
34

BELMONT
2000

18

18
FEB

3303

120	23	24	25	26	27	28	29	30	31	32	33
119											
118											
117											
116											
115											
114											
113											
112											

K
31
~
34

1600 7
BELMONT 1

32	34	35	36	37	38	39	40	41	42	43	20
											19
											18
											17
											16
											15
											14
											13
											12

K
31
34

BELMONT
2000

18

18
PEN

3304

120	23	24	25	26	27	28	29	30	31	32	33
119											
118											
117											
116											
115											
114											
113											
112											

K
31
~
34

1600 K-31
BELMONT 31

33	34	35	36	37	38	39	40	41	42	43	20
											19
											18
											17
											16
											15
											14
											13
											12

K
31
34

BELMONT
2000

18
PEN

3305

120	23	24	25	26	27	28	29	30	31	32	33
19											
18											
17											
16											
15											
14											
13											
12											

K
31
~
34

1600 K
BELMONT

33	34	35	36	37	38	39	40	41	42	43	20 ⁹
											19 ⁹
											18 ⁸
											17 ⁷
											16 ⁶
											15 ⁵
											14 ⁴
											13 ³
											12 ²

K
 31
 31
 BELMONT
 2000

3306

20	23	24	25	26	27	28	29	30	31	32	33
19											
18											
17											
16											
15											
14											
13											
12											

K
31
~
34

1600 K
BELMONT

33

34

35

36

37

38

39

40

41

42

43

20

19

18

17

16

15

14

13

12

K
31
32
33
34

BELMONT
2000

18

18
PEN

3307

20	23	24	25	26	27	28	29	30	31	32	33
19											
18											
17											
16											
15											
14											
13											
12											

K
31
~
34

1600 K
BELMONT

33

34

35

36

37

38

39

40

41

42

43

20

19

18

17

16

15

14

13

12

K
31
32
33
34

BELMONT
2000

18

18
PEN

3308

20	23	24	25	26	27	28	29	30	31	32	33
19											
18											
17											
16											
15											
14											
13											
12											

K
31
~
34

1600 K
BELMONT

33	34	35	36	37	38	39	40	41	42	43	20 ¹
											19 ⁹
											18 ⁸
											17 ⁷
											16 ⁶
											15 ⁵
											14 ⁴
											13 ³
											12 ²

K
31
34

BELMONT
2000

18

18
PEN

3309

20	23	24	25	26	27	28	29	30	31	32	33
19											
18											
17											
16											
15											
14											
13											
12											

K
31
~
34

1600 K-3
BELMONT

33	34	35	36	37	38	39	40	41	42	43	20 9
											19 9
											18 8
											17 7
											16 6
											15 5
											14 4
											13 3
											12 2

K
31
34

BELMONT
2000

18
FEB

3310

20	23	24	25	26	27	28	29	30	31	32	33
19											
18											
17											
16											
15											
14											
13											
12											

K
31
~
34

1600 K
BELMONT

33	34	35	36	37	38	39	40	41	42	43	20 1
											19 9
											18 8
											17 7
											16 6
											15 5
											14 4
											13 3
											12 2

K
31
34

BELMONT
2000

18

18
PER

3311

20	23	24	25	26	27	28	29	30	31	32	33
19											
18											
17											
16											
15											
14											
13											
12											

K
31
~
34

1600 K
BELMONT

32

34

35

36

37

38

39

40

41

42

43

20 9

19 9

18 8

17 7

16 6

15 5

14 4

13 3

12 2

K
31
34

BELMONT
2000

18

18
PER

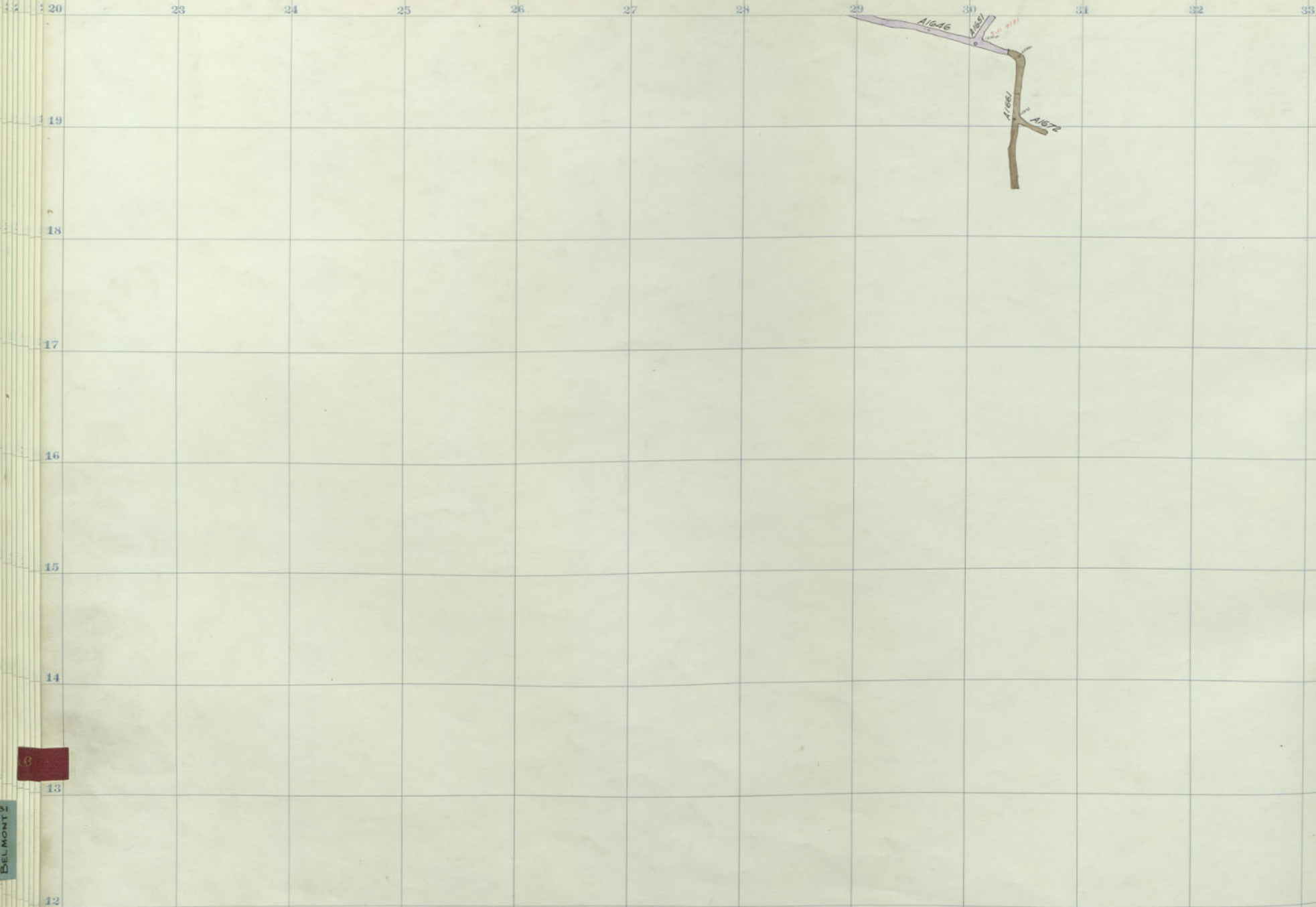

K
31
~
34

8

1600 K-3
BELMONT

Penna. Belmont 1600-Sill
2000-12

33

34

35

36

37

38

39

40

41

42

43

20

19

18

17

16

15

14

13

12

K
31
31

BELMONT
2000

18

FEB

3313

	20	23	24	25	26	27	28	29	30	31	32	33
1:20												
1:19												
1:18												
1:17												
1:16												
1:15												
1:14												
1:13												
1:12												

K
31
~
34

8

1000 K-31
BELMONT

Belmont 2000 Blank

33

34

35

36

37

38

39

40

41

42

43

20

19

18

17

16

15

14

13

12

K
31
34

BELMONT
2000

18
FEB

3314

1:20	23	24	25	26	27	28	29	30	31	32	33
1:19											
1:18											
1:17											
1:16											
1:15											
1:14											
1:13											
1:12											

K
31
~
34

8

1000
BELMONT

33	34	35	36	37	38	39	40	41	42	43	20
											19, 1
											18, 1
											17
											16, 1
											15, 1
											14, 1
											13, 1
											12, 2

K
31
34

BELMONT
2000

18
FEB

3315

20	23	24	25	26	27	28	29	30	31	32	33
1 19											
1 18											
1 17											
1 16											
1 15											
1 14											
1 13											
1 12											

K
31
~
34

1000 K
BELMONT

33 34 35 36 37 38 39 40 41 42 43 20

19 1

18 1

17

16 3

15 3

14 1

13 1

12 2

K
31
34

BELMONT
2000

18
PER

3316

20	23	24	25	26	27	28	29	30	31	32	33
19											
18											
17											
16											
15											
14											
13											
12											

K
31
~
34

G

1000 K
BELMONT 31

33	34	35	36	37	38	39	40	41	42	43	20
											19
											18
											17
											16
											15
											14
											13
											12

K
31
34

BELMONT
2000

18
FEB

3317

20	23	24	25	26	27	28	29	30	31	32	33
19											
18											
17											
16											
15											
14											
13											
12											

K
31
~
34

1600 K-31
BELMONT 31

33 34 35 36 37 38 39 40 41 42 43 20

19

18

17

16

15

14

13

12

K
31
34

BELMONT
2000

18
FEB

3318

20	23	24	25	26	27	28	29	30	31	32	33
19											
18											
17											
16											
15											
14											
13											
12											

K
31
~
34

3

1600
K-31
BELMONT

33

34

35

36

37

38

39

40

41

42

43

20

19

18

17

16

15

14

13

12

K
31
34

BELMONT
2000

18

3319

20	23	24	25	26	27	28	29	30	31	32	33
19											
18											
17											
16											
15											
14											
13											
12											

K
31
~
34

6

1000 K
BELMONT 3

33

34

35

36

37

38

39

40

41

42

43

20

19

18

17

16

15

14

13

12

K
31
34

BELMONT
2000

18
780

220 23 24 25 26 27 28 29 30 31 32 33

119

118

117

116

115

114

13

112

K
31
~
34

3

1000 K
BELMONT 3

33

34

35

36

37

38

39

40

41

42

43

20

19

18

17

16

15

14

13

12

K
31
34

BELMONT
2000

18
FEB.

220	23	24	25	26	27	28	29	30	31	32	33
119											
118											
117											
116											
115											
114											
13											
12											

K
31
~
34

1000 K
BELMONT

33

34

35

36

37

38

39

40

41

42

43

20

19

18

17

16

15

14

13

12

K
31
34

BELMONT
2000

18
PER.

3322

20	23	24	25	26	27	28	29	30	31	32	33
19											
18											
17											
16											
15											
14											
13											
12											

K
31
~
34

8

1000 K-31
BELMONT 31

32	34	35	36	37	38	39	40	41	42	43	20
											19 ³
											18 ⁴
											17 ⁷
											16 ³
											15 ⁵
											14 ⁴
											13 ³
											12 ²

K
31
34

BELMONT
2000

18
FEB.

3823

	20	23	24	25	26	27	28	29	30	31	32	33
1 19												
1 18												
1 17												
1 16												
1 15												
1 14												
1 13												
1 12												

K
31
~
34

3

1000 K-3
BELMONT

33 34 35 36 37 38 39 40 41 42 43 20

19¹

18¹

17¹

16³

15⁵

14⁴

13³

12²

K
31
34

BELMONT
2000

18
FEB.

3324

	20	23	24	25	26	27	28	29	30	31	32	33
1 19												
1 18												
1 17												
1 16												
1 15												
1 14												
1 13												
1 12												

K
31
~
34

8

1000 K-31
BELMONT 31

33 34 35 36 37 38 39 40 41 42 43

20

19

18

17

16

15

14

13

12

K
31
34

BELMONT
2000

18
FEB.

3325

20 23 24 25 26 27 28 29 30 31 32 33

19

18

17

16

15

BELMONT
2000

14

13



1000
K
BELMONT

12

Pennsylvania
Belmont 1800-19th Fl.
2000 Sill

K
31
~
34

33

34

35

36

37

38

39

40

41

42

43

20

19

18

17

16

15

14

13

12

K
31
34

18

FEB

20 23 24 25 26 27 28 29 30 31 32 33

19

18

17

16

15

BELMONT
2000

14

13

1000
K-3
BELMONT

12

Perm. 1500-18

K
31
~
34

32

34

35

36

37

38

39

40

41

42

43

20

19

18

17

16

15

14

13

12

K
31
34

18

FEB

20 23 24 25 26 27 28 29 30 31 32 33

19

18

17

16

15

BELMONT
2000

14

13

1000 K
BELMONT 3

12

Penna. 1800-17

K
31
~
34

33

34

35

36

37

38

39

40

41

42

43

20

19

18

17

16

15

14

13

12

K
31
31
34

18

PER.

19

18

17

16

15

14

13

12

K
31
~
34

BELMONT
2000

1000 K
BELMONT 31

Penna 1800-16

33

34

35

36

37

38

39

40

41

42

43

20

19

18

17

16

15

14

13

12

1800

K
31
34

18

PER.

3329

20 23 24 25 26 27 28 29 30 31 32 33

19

18

17

16

15

BELMONT
2000

14

13

1000
K-3
BELMONT

12

Penna

1800-15

K
31
~
34

32

34

35

36

37

38

39

40

41

42

43

20

19

18

17

16

15

14

13

12

1800

K
31
34

18

FEB.

20	23	24	25	26	27	28	29	30	31	32	33
19											
18											
17											
16											
15											
14											
13											
12											

Penna. 1800-14

K
31
~
34

BELMONT
2000

1000 K-31
BELMONT 31

33 34 35 36 37 38 39 40 41 42 43 20

19¹

18¹

17¹

16¹

15⁵

14¹

13³

12²

1800

K
31
34

18
PER.

3331

20 23 24 25 26 27 28 29 30 31 32 33

19

18

17

16

15

BELMONT
2000

14

13

1000 K
BELMONT 31

12

Penna 1800-13

K
31
~
34

33 34 35 36 37 38 39 40 41 42 43 20

19

18

17

16

15

14

13

12

1800 13

K
31
34

18
FEB.

3332

20 23 24 25 26 27 28 29 30 31 32 33



19

18

17

16

15

14

13

12

K
31
~
34

BELMONT
2000

1000 K
BELMONT

Penna. 1800-12

33

34

35

36

37

38

39

40

41

42

43

20

19

18

17

16

15

14

13

12

1800

12

K
31
34

18

3333

20 23 24 25 26 27 28 29 30 31 32 33

19

18

17

16

15

14

13

12

K
31
~
34

BELMONT
2000

6

1000
K
BELMONT

Penna

1800-11



33

34

35

36

37

38

39

40

41

42

43

20

19

18

17

16

15

14

13

12

1800

11

K
31
34

18
PER

3334

20 23 24 25 26 27 28 29 30 31 32 33



19

18

17

16

15

BELMONT
2000

14

6

13

1000 K
BELMONT 2

12

Penna.

1800-10

K
31
~
34

32 34 35 36 37 38 39 40 41 42 43 20

19

18

17

16

15

14

13

12

K
31
34

20 23 24 25 26 27 28 29 30 31 32 33

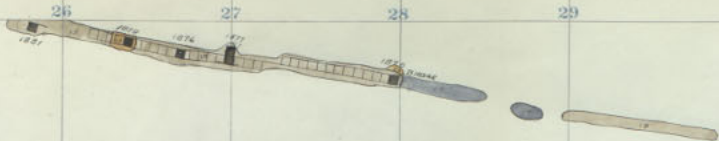

19

18

17

16

15

14

13

12

Penna. 1800-9

K
31
~
34

BELMONT
2000

6

1000 K
BELMONT

32 34 35 36 37 38 39 40 41 42 43 20

19'

18'

17'

16'

15'

14'

13'

12'

K
31
34

20 23 24 25 26 27 28 29 30 31 32 33

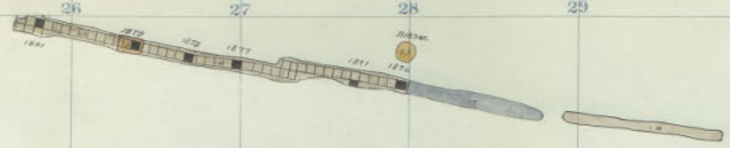

K
31
~
34

BELMONT
2000

1600 K
BELMONT

33

34

35

36

37

38

39

40

41

42

43

20

19

18

17

16

15

14

13

12

K
31
34

1800

8

18
PER

3337

20 23 24 25 26 27 28 29 30 31 32 33

19

18

17

16

15

14

13

12

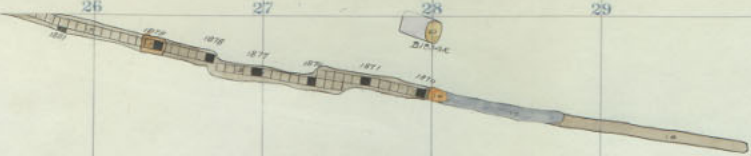

Penn. 1800-7

K
31
~
34

BELMONT
2000

5

1600
K-3
BELMONT

33 34 35 36 37 38 39 40 41 42 43 20

19

18

17

16

15

14

13

12

K
31
34

3338

20 23 24 25 26 27 28 29 30 31 32 33

19

18

17

16

15

14

13

12

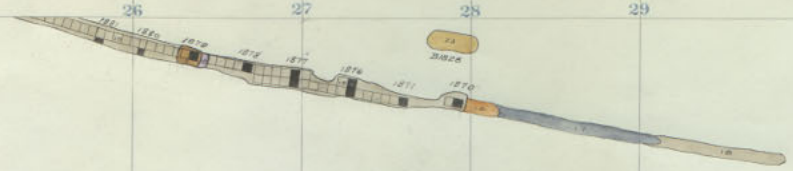

Penna. 1800-6

K
31
~
34

BELMONT
2000

1600
K
BELMONT

33

34

35

36

37

38

39

40

41

42

43

20

19

18

17

16

15

14

13

12

K
31
34

1800

6

18
PER

3339

20 23 24 25 26 27 28 29 30 31 32 33

19

18

17

16

15

14

13

12

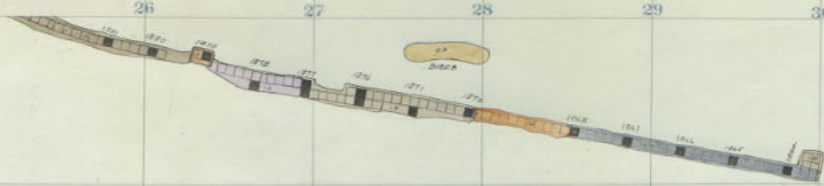

Penna. 1800-5

K
31
34

BELMONT
2000

1000
K
BELMONT

33 34 35 36 37 38 39 40 41 42 43 20

19

18

17

16

15

14

13

12

1860 5

K
31
34

18
FEB.

20 23 24 25 26 27 28 29 30 31 32 33

19

18

17

16

15

14

13

12

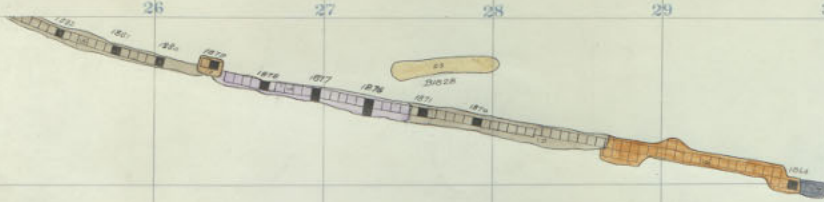

K
31
~
34

BELMONT
2000

1000
K-31
BELMONT

33 34 35 36 37 38 39 40 41 42 43 20

19

18

17

16

15

14

13

12

1860 4

K
31
34

18
PER.

33

34

35

36

37

38

39

40

41

42

43

20

19

18

17

16

15

14

13

12

1800

3

K
31
34

18
PER.

3342

20 23 24 25 26 27 28 29 30 31 32 33

19

18

17

16

15

14

13

12

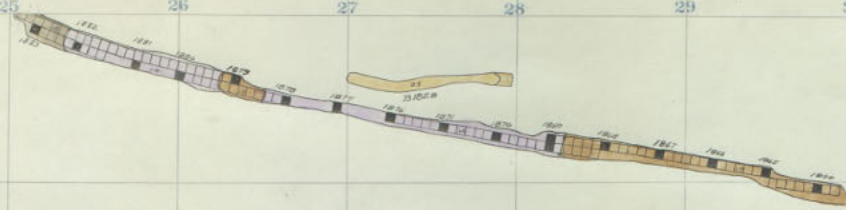

K
31
34

BELMONT
2000

1000
K-3
BELMONT

Penna. 1800-2

33

34

35

36

37

38

39

40

41

42

43

20

19

18

17

16

15

14

13

12

K
31
34

1800

2

18
PER.

3343

20 23 24 25 26 27 28 29 30 31 32 33

19

18

17

16

15

14

13

12

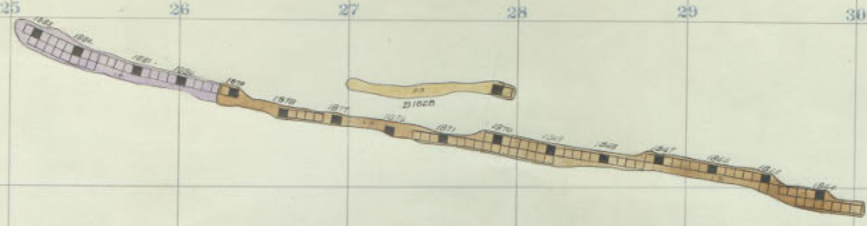

Penna. 1800-1

K
31
~
34

BELMONT
2000

1000
K-31
BELMONT

33

34

35

36

37

38

39

40

41

42

43

20

19

18

17

16

15

14

13

12

K
31
34

1800

1

13

FEB.

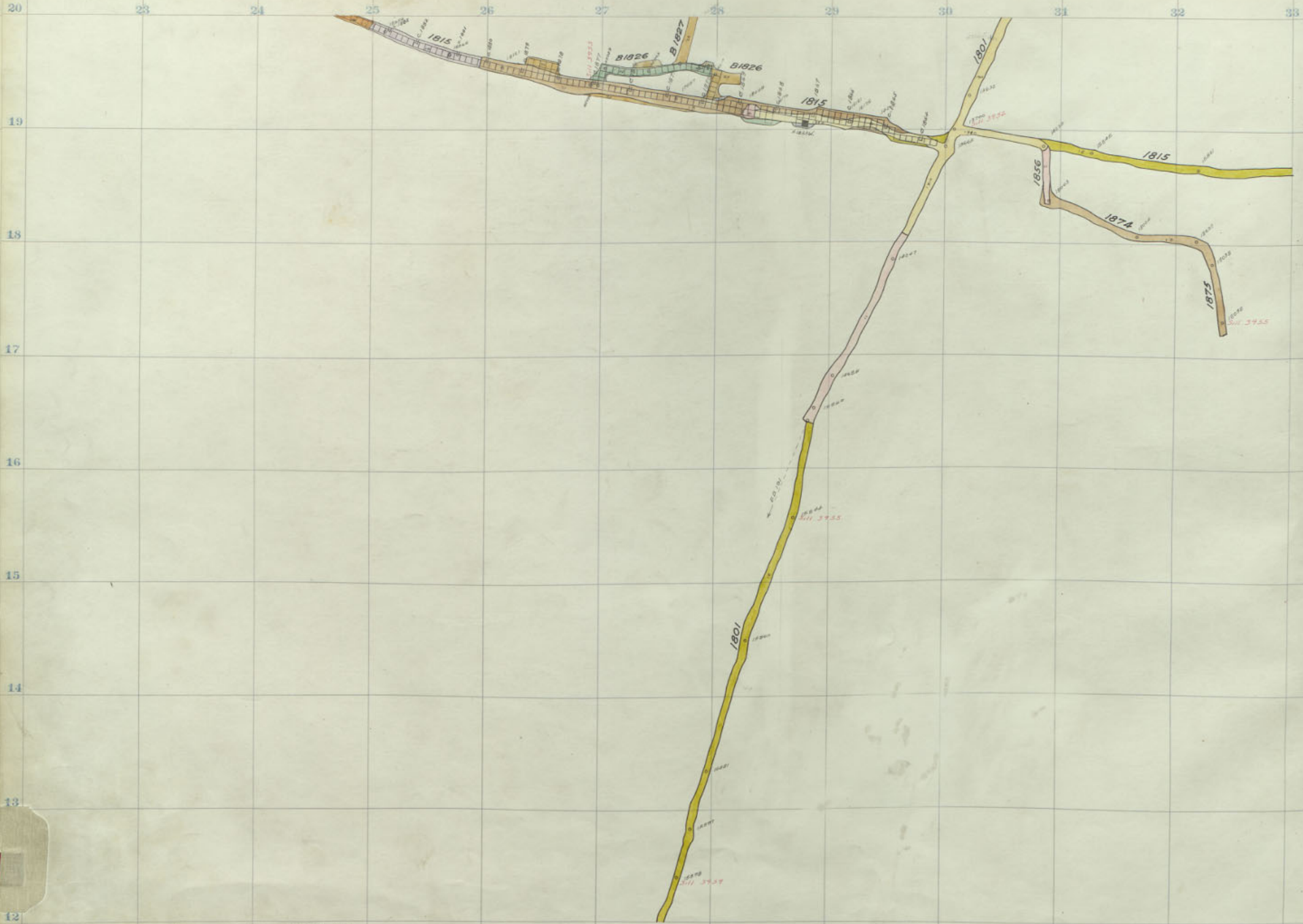

K
31
~
34

BELMONT
2000

1000
K
BELMONT
18
PEN.

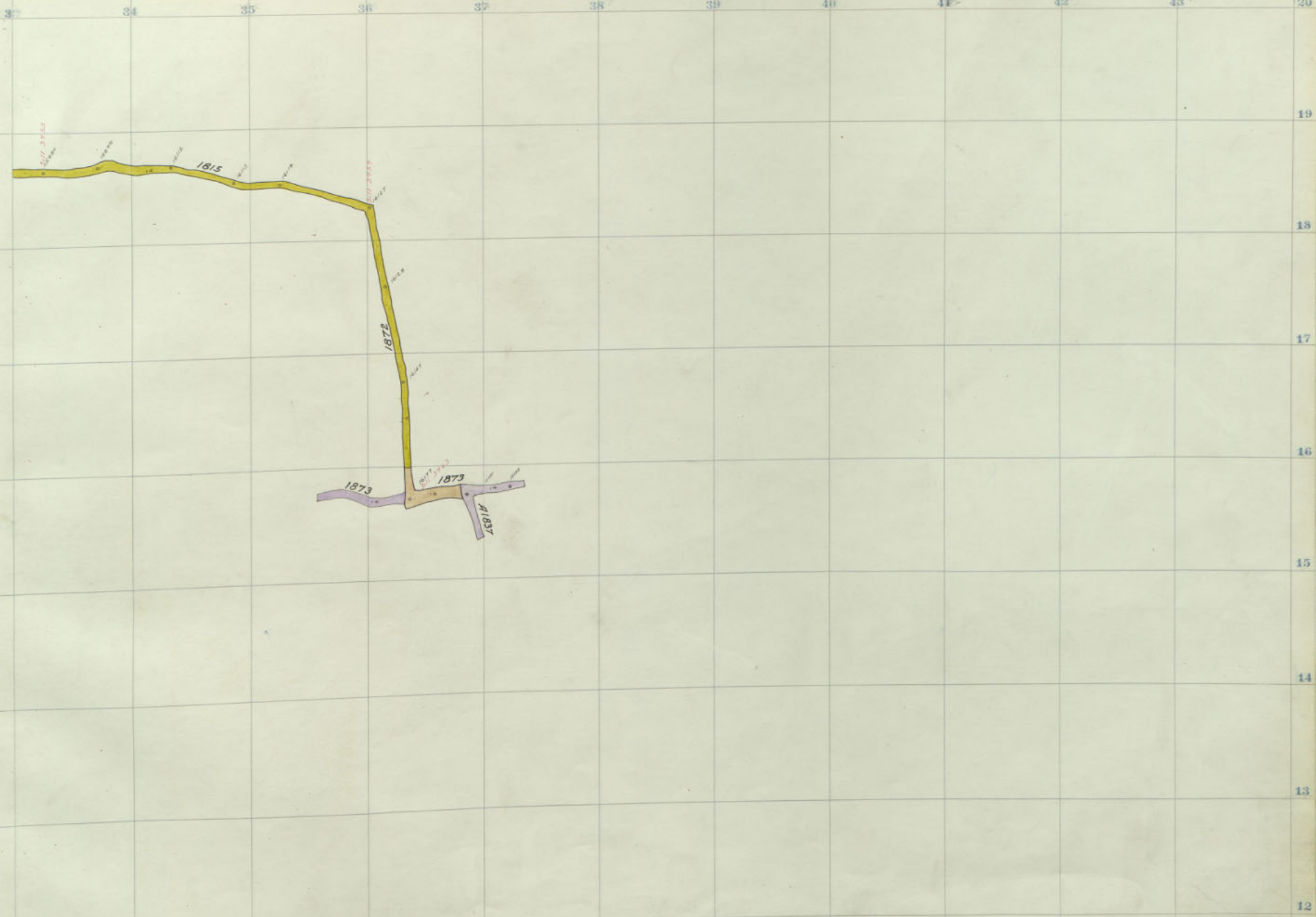

K
31
34

3845

20	23	24	25	26	27	28	29	30	31	32	33
19											
18											
17											
16											
15											
14											
13											
12											

K
31
~
34

BELMONT
2000

9

1000
K
BELMONT 31

10
PEN.

33

34

35

36

37

38

39

40

41

42

43

20

19

18

17

16

15

14

13

12

K
31
34

3346

	20	23	24	25	26	27	28	29	30	31	32	33
19												
18												
17												
16												
15												
14												
13												
12												

K
31
~
34

BELMONT
2000

1000 K-3
BELMONT

FEB. 03

33

34

35

36

37

38

39

40

41

42

43

20

19

18

17

16

15

14

13

12

K
31
34

3347

20	23	24	25	26	27	28	29	30	31	32	33
19											
18											
17											
16											
15											
14											
13											
12											

K
31
~
34

BELMONT
2000

1000 K-3
BELMONT
PEN, 10

33

34

35

36

37

38

39

40

41

42

43

20

19

18

17

16

15

14

13

12

K
31
34

3348

20	23	24	25	26	27	28	29	30	31	32	33
19											
18											
17											
16											
15											
14											
13											
12											

K
31
~
34

BELMONT
2000

9

1000
K-3
BELMONT 31

PKN 10

33

34

35

36

37

38

39

40

41

42

43

20

19

18

17

16

15

14

13

12

K
31
34

3349

20	23	24	25	26	27	28	29	30	31	32	33
19											
18											
17											
16											
15											
14											
13											
12											

K
31
~
34

BELMONT
2000

3

1000
K-3
BELMONT

10
PEN

33 34 35 36 37 38 39 40 41 42 43 20

19

18

17

16

15

14

13

12

K
31
34

3350

20	23	24	25	26	27	28	29	30	31	32	33
19											
18											
17											
16											
15											
14											
13											
12											

K
31
~
34

BELMONT
2000

1000 K-3
BELMONT

10
10

33

34

35

36

37

38

39

40

41

42

43

20

19

18

17

16

15

14

13

12

K
31
34

3351

20	23	24	25	26	27	28	29	30	31	32	33
19											
18											
17											
16											
15											
14											
13											
12											

K
31
~
34

BELMONT
2000

1000
K-31
BELMONT

PER.

32

34

35

36

37

38

39

40

41

42

43

20

19

18

17

16

15

14

13

12

K
31
34

3352

20

19

18

17

16

15

14

13

12

K
31
~
34

BELMONT
2000

1000 K
BELMONT 31

10
724

K
31
34

3852

20

19

18

17

16

15

BELMONT
2000

14

13

1600 K
BELMONT 31

1600
K 31

12

K
31
31

K
31
34



5

STOPE

BOOK

3-4

13-18

PENNSYLVANIA

AND

SILVER BOW

MINES

K
31