

MISC. 3

MISC*3

L-15, L-16

L-17, L-18

L-19, L-20

L-25, L-26

L-29, L-30

M-11, M-12

M-13, M-14

M-15, M-16









M-17, M-18

M-19, M-20

M-21, M-22



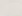

223	224	225	226	227	228	229	230	231	232	233	234
										ANS. AIR SH.  329 300-36	329
										ANS. AIR SH.  329 300-35	329
										ANS. AIR SH.  329 300-34	329
										ANS. AIR SH.  329 300-33	329
										ANS. AIR SH.  329 300-32	329
										ANS. AIR SH.  329 300-31	329
										ANS. AIR SH.  329 300-30	329
										ANS. AIR SH.  329 300-29	329

M-21
ANSELMO AIR SH.
300' TUNNEL

M-21
ANSELMO AIR SH.
61' TUNNEL

ANSELMO AIR SHAFT-61 TUNNEL (300-29)
COMPOSITE ANSELMO AIR SH. 61 TUNNEL TO SURFACE
M-21

								013		
								013	328 1018	
								013	PPF AIR SH 300-28	
								013	328 1018	
								233	PPF 300-27	
								233	328 1018	
								233	PPF 300-26	
								233	328 1018	
								233	PPF 300-25	
								233	328 1018	
								233	PPF AIR SH 300-24	

COMPOSITE ANSELMO AIR SH-101 RAISE

M AN SELMO
AIR SHAPT 300

M O GILL
500

223 224 225 226 227 228 229 230 231 232 233 234

336
335
334
333
332
331
330
329
328

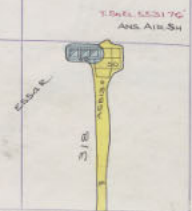

M-21
ANSELMO
AIR SHAFT 300

M-21
O GIBL
500

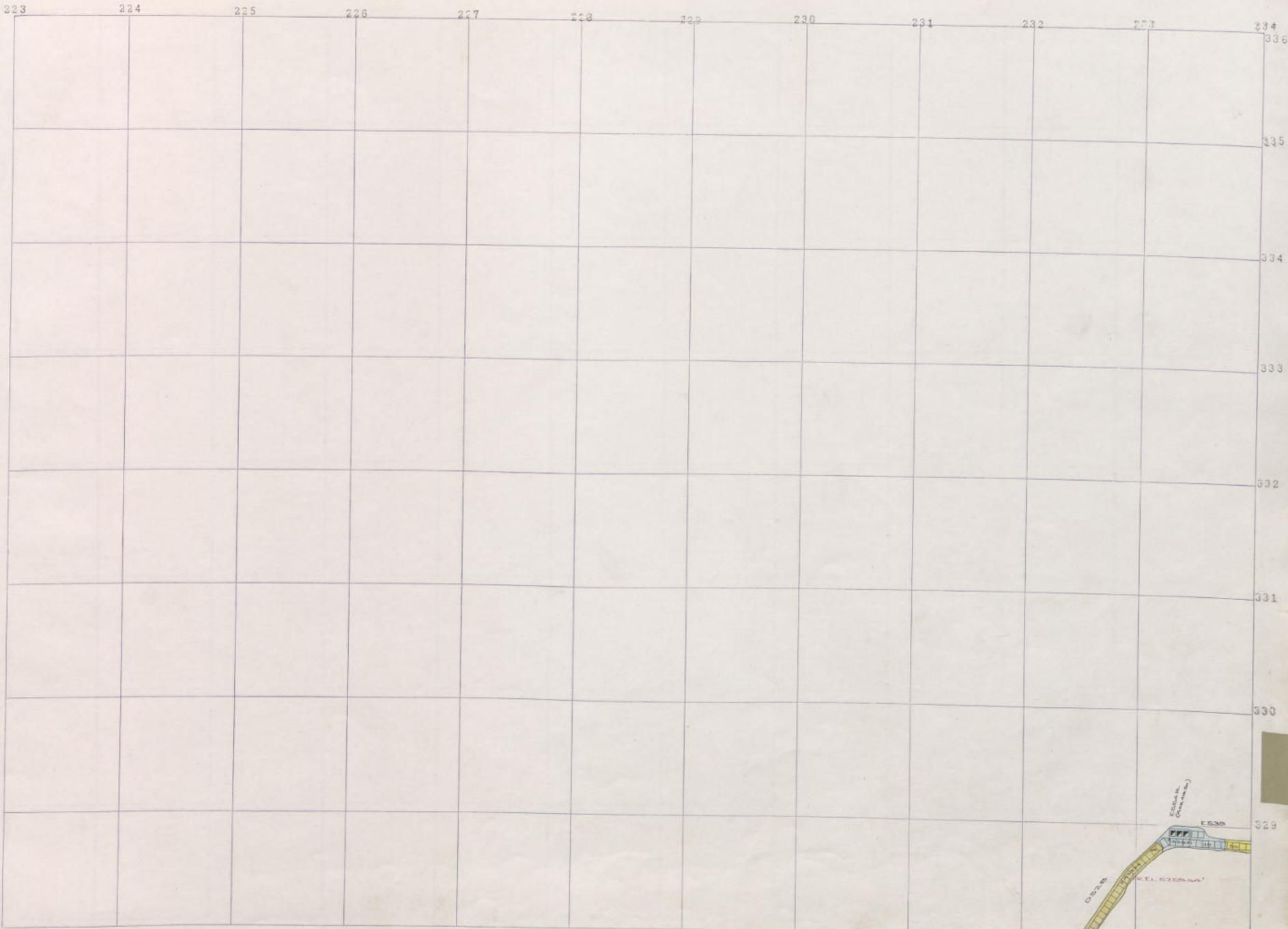

O. GIRL 500 - M22

ORPHAN GIRL 500 SILL

M22

O. GIRL
500



